



jordan fishwick

WEST DIDSBURY
Old Lansdowne Road



Old Lansdowne Road, West Didsbury, M20 2WU

Guide Price £325,000



The Property

A most appealing, TWO DOUBLE BEDROOM, duplex apartment forming part of an ATTRACTIVE PERIOD CONVERSION with a GREAT LOCATION in the heart of WEST DIDSBURY and easy access to BURTON ROAD & THE METROLINK. 821 sq ft. The stylish living space is arranged over two floors and benefits from both gas central heating and uPVC double glazing with a generous L-shaped entrance hall, separate living room, spacious dining kitchen with a range of fitted units and integrated appliances, two double bedrooms with ample space for freestanding furniture and an ensuite to the main and a further contemporary bathroom with chrome fittings. The property enjoys a great position on the corner of Old Lansdowne Road and Queenston Road, with easy access to the bars & restaurants on Burton Road and the nearby Metrolink. There are attractive communal gardens and a residents car park with allocated space.

Directions

M20 2WU



- Stylish duplex apartment
- Two double bedrooms
- Bathroom & En-suite shower room
- Dining kitchen
- Integrated appliances
- Gas central heating
- Double glazing
- Communal garden
- Residents parking
- Great location

Postcode - M20 2WU

EPC Rating - D

Floor Area - 821.00 sq ft

Local Authority - Manchester City Council

Council Tax - C



2ND FLOOR
523 sq.ft. (48.6 sq.m.) approx.

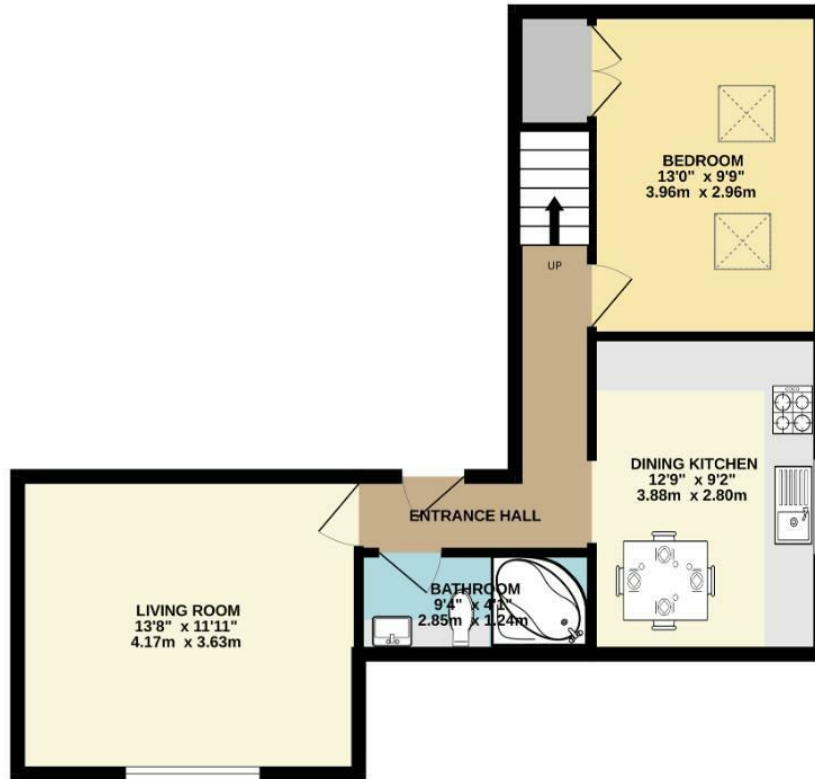

3RD FLOOR
297 sq.ft. (27.6 sq.m.) approx.



TOTAL FLOOR AREA : 821 sq.ft. (76.2 sq.m.) approx.
Measurements are approximate. Not to scale. Illustrative purposes only
Made with Metropix ©2026



These particulars are believed to be accurate but they are not guaranteed and do not form a contract. Neither Jordan Fishwick nor the vendor or lessor accept any responsibility in respect of these particulars, which are not intended to be statements or representations of fact and any intending purchaser or lessee must satisfy himself by inspection or otherwise as to the correctness of each of the statements contained in these particulars. Any floorplans on this brochure are for illustrative purposes only and are not necessarily to scale.

Offices also at: Wilmslow, Macclesfield, Hale, Sale, Chorlton, Glossop, Manchester & Salford

757-759 Wilmslow Road, Didsbury Village, Manchester

0161 445 4480

didsbury@jordanfishwick.co.uk
www.jordanfishwick.co.uk